

<b>Ø"</b>	<b>1/4"</b>	<b>3/8"</b>	<b>1/2"</b>	<b>3/4"</b>	<b>1"</b>	<b>1"1/4</b>	<b>1"1/2</b>	<b>2"</b>	<b>2"1/2</b>	<b>3"</b>	<b>4"</b>
<b>A</b>	46	48	58	69	81	94	99	115	141	165	210
<b>L</b>	11	11	13	14	17	19	19	22	25	27	30
<b>B</b>	90	90	90	115	115	150	150	180	270	270	320
<b>B1</b>	45	45	60	70	70	-	-	-	-	-	-
<b>H</b>	41	41	45	57	60	75	81	96	112	123	162
<b>d</b>	10	10	14	20	25	31	39	49	63	76	100
<b>P gr ~</b>	150	155	240	465	605	1.025	1.420	1.825	3.160	4.820	10.460

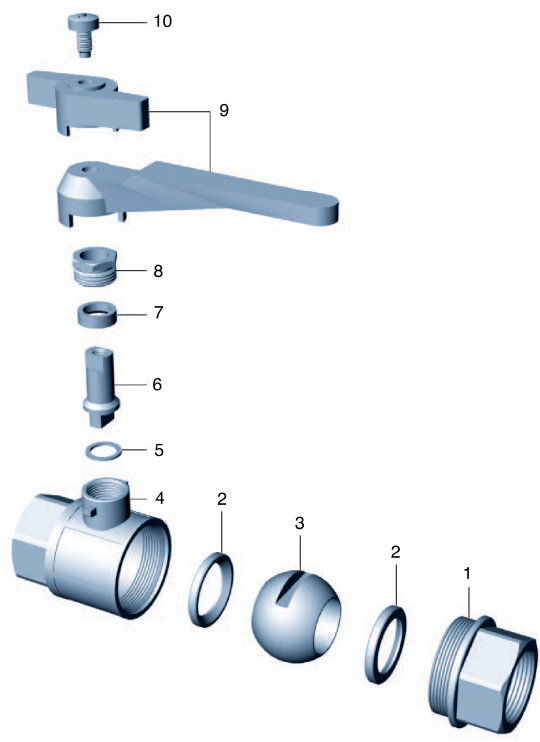
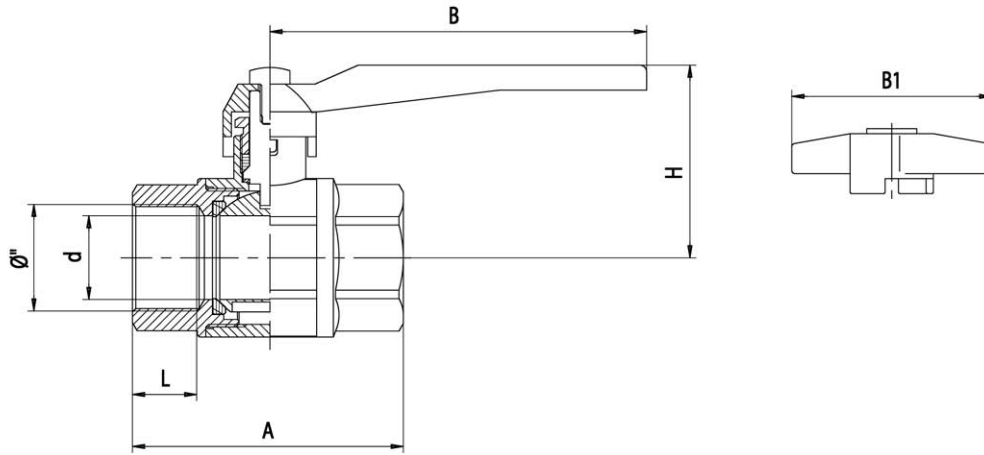

**Condizioni di esercizio**

Work conditions

<b>DN</b>	<b>1/4" ÷ 1"</b>	<b>1"1/4 ÷ 2"</b>	<b>2"1/2 ÷ 4"</b>
<b>P (Bar)</b>	32	25	16
<b>P (PSI)</b>	460	360	230
<b>T °C</b>	-15 +80		

**Filettatura: gas cilindrica UNI EN ISO 228/1 (standard)  
conica NPT USAS B 2.1 (a richiesta)**  
Thread: BSP parallel UNI ISO 228/1 (standard)  
conical NPT USAS B 2.1 (on request)

**Maniglia a farfalla a richiesta**  
Throttle handle on request

	<b>CODICE / CODE</b>	<b>DENOMINAZIONE</b>	<b>DENOMINATION</b>	<b>MATERIALE</b>	<b>MATERIAL</b>
1	SOIN 756 (DN) 001	MANICOTTO	SLEEVE	OTTONE UNI EN 12165	UNI EN 12165 BRASS
2	GTEF 756 (DN) 002	GUARNIZIONE	GASKET	P.T.F.E.	P.T.F.E.
3	SOIN 756 (DN) 003	SFERA	BALL	OTTONE UNI EN 12165	UNI EN 12165 BRASS
4	SOIN 756 (DN) 004	CORPO	BODY	OTTONE UNI EN 12165	UNI EN 12165 BRASS
5	GTEF 756 (DN) 005	ANELLO	RING	P.T.F.E.	P.T.F.E.
6	TOIN 756 (DN) 006	PERNO	PIN	OTTONE UNI EN 12164	UNI EN 12164 BRASS
7	GTEF 756 (DN) 007	GUARNIZIONE	GASKET	P.T.F.E.	P.T.F.E.
8	TOIN 756 (DN) 008	PREMISTOPPA	NUT	OTTONE UNI EN 12164	UNI EN 12164 BRASS
9	SAIN 756 (DN) 009	MANIGLIA	HANDLE	ALLUMINIO	ALUMINIUM
9	SAIN 756 (DN) 09F	MANIGLIA A FARFALLA	THROTTLE HANDLE	ALLUMINIO	ALUMINIUM
10	VTAC 756 (DN) 010	VITE	SCREW	ACCIAIO ZINCATO	ZINC PLATED STEEL