

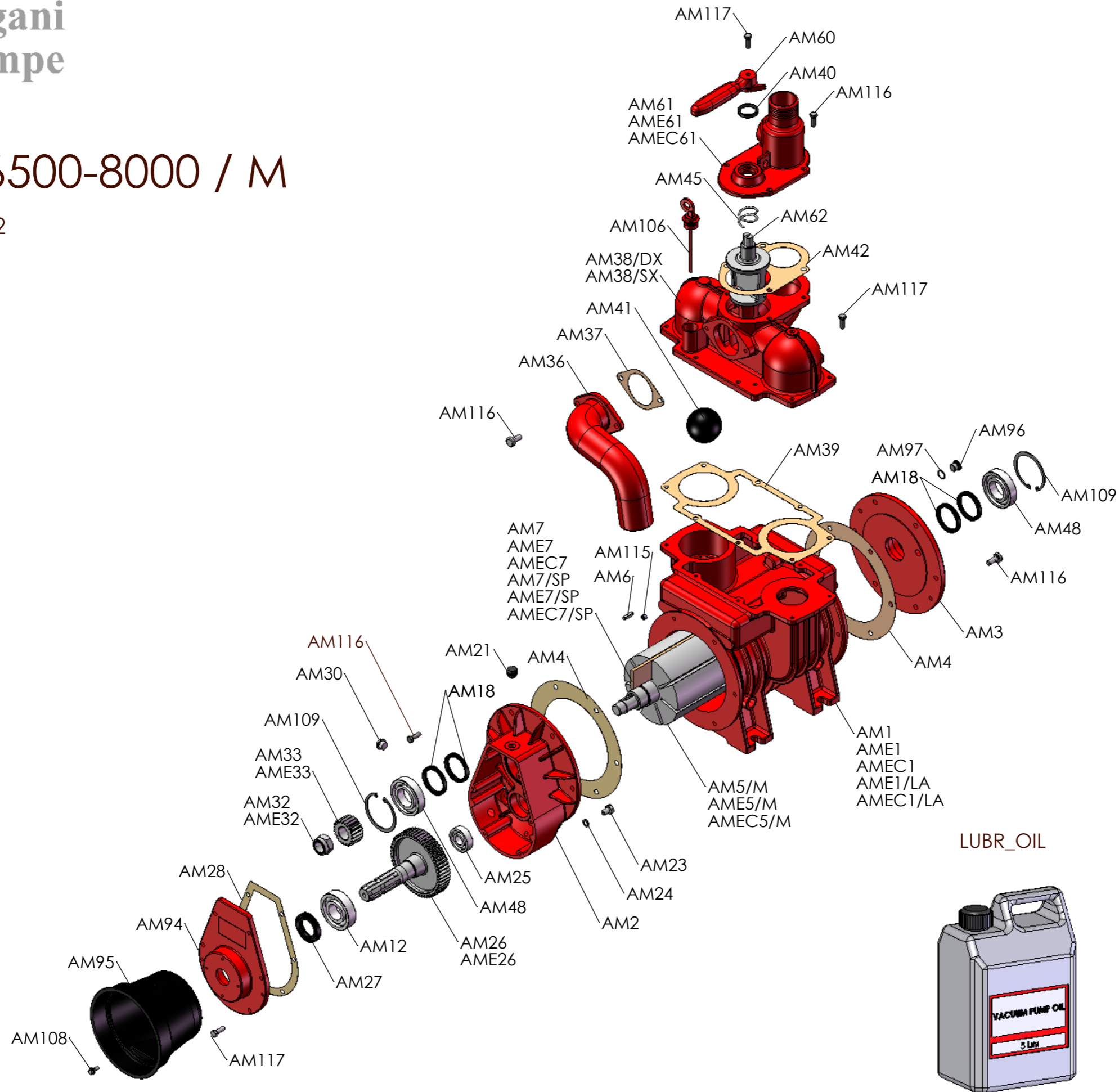

**Battioni®  
Pagani  
Pompe**

# MEC 5000-6500-8000 / M

Rel. 0 dated 01/03/2012



- AM117
- AM60
- AM40
- AM61
- AME61
- AMEC61
- AM45
- AM106
- AM62
- AM38/DX
- AM38/SX
- AM42
- AM41
- AM37
- AM36
- AM116
- AM39
- AM97
- AM96
- AM18
- AM109
- AM48
- AM116
- AM3
- AM7
- AME7
- AMEC7
- AM7/SP
- AME7/SP
- AMEC7/SP
- AM115
- AM6
- AM4
- AM3
- AM4
- AM1
- AME1
- AMEC1
- AME1/LA
- AMEC1/LA
- AM5/M
- AME5/M
- AMEC5/M
- AM21
- AM4
- AM18
- AM109
- AM116
- AM30
- AM33
- AME33
- AM32
- AME32
- AM28
- AM94
- AM95
- AM108
- AM117
- AM27
- AM12
- AM26
- AME26
- AM25
- AM48
- AM23
- AM24
- AM2

LUBR\_OIL

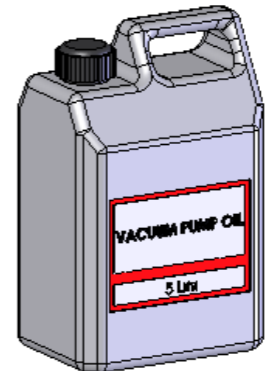

REBUILD KIT

- AM123
- AME123
- AMEC123
- AM123/SP
- AME123/SP
- AMEC123/SP

